

# PRODUCT INFORMATION PACKET



Model No: CZ143T34WK12A

Catalog No: 122210.00

122210.00..1.5HP..3490RPM.145JM.TEFC.230/460V.3PH.60HZ.CONT.40C.1.15SF.RIGID C  
FACE.CZ143T34WK12.....STAINLESS JM PUMP.NONE.....

JM Pump



Regal and Leeson are trademarks of Regal Beloit Corporation or one of its affiliated companies.

©2018 Regal Beloit Corporation, All Rights Reserved. MC017097E



**Product Information Packet: Model No: CZ143T34WK12A, Catalog No:122210.00  
 122210.00..1.5HP..3490RPM.145JM.TEFC.230/460V.3PH.60HZ.CONT.40C.1.15SF.RIGID C  
 FACE.CZ143T34WK12.....STAINLESS JM PUMP.NONE.....**



### Nameplate Specifications

Output HP	<b>1.50 Hp</b>	Output KW	<b>1.1 kW</b>
Frequency	<b>60 Hz</b>	Voltage	<b>230/460 V</b>
Current	<b>4.0/2.0 A</b>	Speed	<b>3490 rpm</b>
Service Factor	<b>1.15</b>	Phase	<b>3</b>
Efficiency	<b>84 %</b>	Duty	<b>Continuous</b>
Insulation Class	<b>F</b>	Design Code	<b>B</b>
KVA Code	<b>M</b>	Frame	<b>143JM</b>
Enclosure	<b>Totally Enclosed Fan Cooled</b>	Overload Protector	<b>No</b>
Ambient Temperature	<b>40 °C</b>	Drive End Bearing Size	<b>6206</b>
Opp Drive End Bearing Size	<b>6203</b>	UL	<b>Recognized</b>
CSA	<b>Y</b>	CE	<b>Y</b>
IP Code	<b>56</b>		

### Technical Specifications

Electrical Type	<b>Squirrel Cage Inverter Rated</b>	Starting Method	<b>Line Or Inverter</b>
Poles	<b>2</b>	Rotation	<b>Reversible</b>
Mounting	<b>Rigid base</b>	Motor Orientation	<b>HORIZONTAL</b>
Drive End Bearing	<b>BALL</b>	Opp Drive End Bearing	<b>BALL</b>
Frame Material	<b>Stainless Steel</b>	Shaft Type	<b>JM</b>
Overall Length	<b>16.50 in</b>	Frame Length	<b>9.00 in</b>
Shaft Diameter	<b>0.875 in</b>	Shaft Extension	<b>4.28 in</b>
Assembly/Box Mounting	<b>F1 ONLY</b>		
Outline Drawing	<b>607-0234-900</b>	Connection Diagram	<b>005010.01</b>

**This is an uncontrolled document once printed or downloaded and is subject to change without notice. Date Created: 10/15/2018**

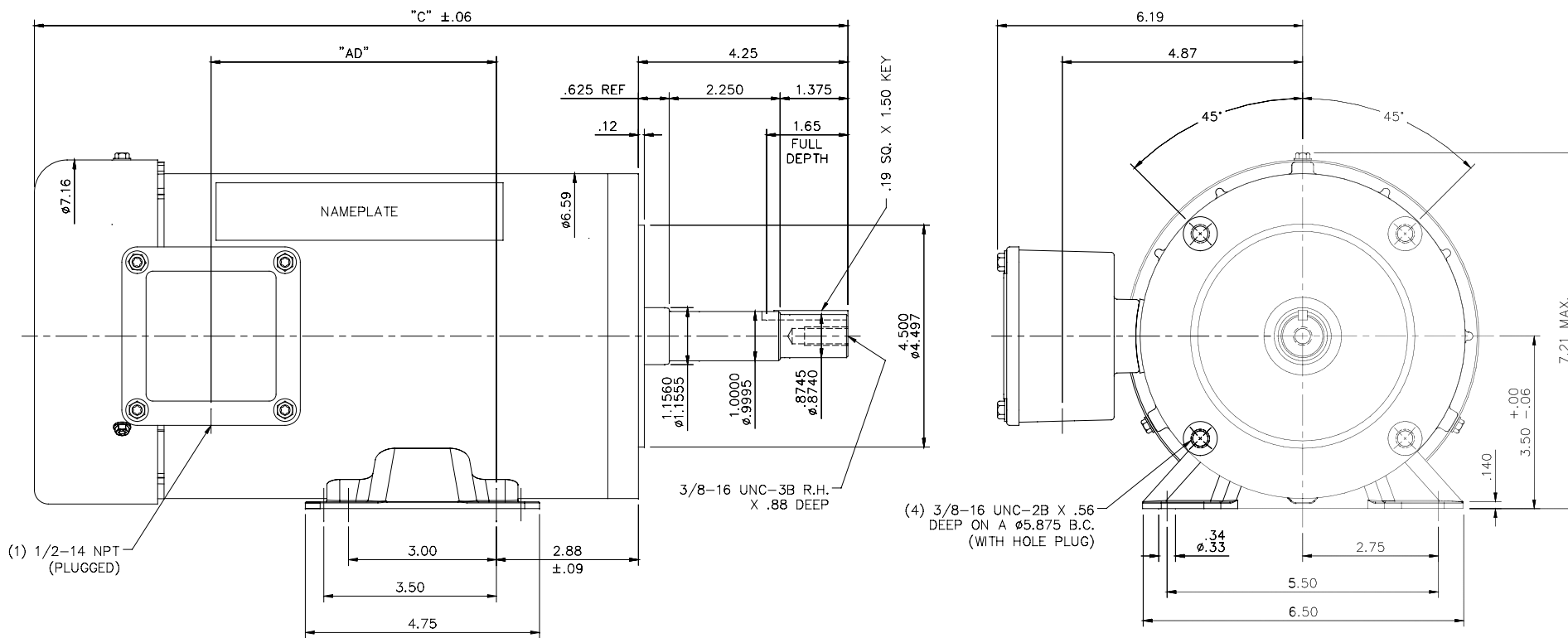

DASH NO.	"C"	"AD"
850	16.00	5.29
900	16.50	5.79
950	17.00	6.29

MAXIMUM FACE RUNOUT TO BE .004 T.I.R.  
 MAXIMUM PILOT ECCENTRICITY .004 T.I.R.  
 PERMISSIBLE SHAFT RUNOUT .002 T.I.R.

**ALL-STAINLESS**  
 VITON CONDUIT BOX & COVER GASKETS  
 VITON O-RINGS IN ENDBELL RABBETS & UNDER THRU BOLT HEADS  
 VITON SHAFT SEALS  
 BREATHER PLUGS IN CONDUIT BOX & L.E. ENDBELL  
 ALL STAINLESS STEEL CONSTRUCTION

ORACLE REV	NO.	REVISION	BY & DATE	TOLERANCES UNLESS SPECIFIED		CHK	ANG	FINISH	CAD FILE	SIZE	DRAWING NO.	REV.
				DEC.	INCHES							
00		THIS DRAWING IN DESIGN AND DETAIL IS OUR PROPERTY AND MUST NOT BE USED EXCEPT IN CONNECTION WITH OUR WORK ALL RIGHTS OF DESIGN AND INVENTION ARE RESERVED THIS IS AN ELECTRONICALLY GENERATED DOCUMENT - DO NOT SCALE THIS PRINT			.X	±.1			028620	B	607-0234	A

**LEESON** ELECTRIC MOTORS  
 GEARMOTORS  
 AND DRIVES

TITLE: OUTLINE - 143JM FRAME  
 TEFC - RIGID "C"

MAT'L: STAINLESS STEEL DUCK JM PUMP

DRAWN: ARV 2/9/16  
 CHK: SK 2/9/16  
 SCALE: 1=2  
 REF: FMF  
 PREV:

005010-01

VIEW FROM OUTSIDE OF MOTOR AT SWITCH END.



VOLTAGE	L1	L2	L3	JOIN & INSULATE
HIGH	T1	T2	T3	(T4,T7) (T5,T8) (T6,T9)
LOW	T1,T7	T2,T8	T3,T9	T4,T5,T6

				TOLERANCES UNLESS SPECIFIED		<b>Regal Beloit America, Inc.</b>		DRAWN RDW 04/12/02				
				DEC.	INCHES			CHK				
				.X	±.1			APPD				
				.XX	±.01			SCALE 1=1				
				.XXX	±.005	TITLE		REF FIG.2-51				
A	UPDATED TO REGAL LOGO			SAJ	06/26/15	AJY	.XXXX	±.0005	MAT'L. DECAL - 004014	FMF		
NO.	REVISION			BY & DATE	CHK	ANG	±1/2"	FINISH	PREV			
THIS DRAWING IN DESIGN AND DETAIL IS OUR PROPERTY AND MUST NOT BE USED EXCEPT IN CONNECTION WITH OUR WORK ALL RIGHTS OF DESIGN AND INVENTION ARE RESERVED THIS IS AN ELECTRONICALLY GENERATED DOCUMENT - DO NOT SCALE THIS PRINT				RFP	04/12/02		CAD FILE	00501001		SIZE	DRAWING NO.	REV.
				DIST	BRF-NLV				A	005010-01		A

